



Fireplace Capilla

General data and commercial

Model: Capilla
RS: A/1
Weight: 60 Kg.
Width: 450 mm.
Height: 2910 mm.
Long: 470 mm.

Construction details and material

Fireplace: Set made of sheet steel polished 2mm thick.

Tube: Made of sheet steel polished 2mm thick.

Grill: Made of steel rods.

Interior Section: Made of plate steel polished 4mm thick. Between the inside section and the hood there is an air chamber.

Painting: The set is painted with glaze anticaloric-component, with colour matte black, with a thermal resistance of 950 ° C.

TRANSPORT INFORMATION:

CAGE: 3100 x 580 x 650 mm. (Length x Height x Width)

WEIGHT: 110 Kg. TRUCK METERS: 3 m.

DAE Chimeneas reserves the right to make changes and / or changes in the products and specifications without notice.

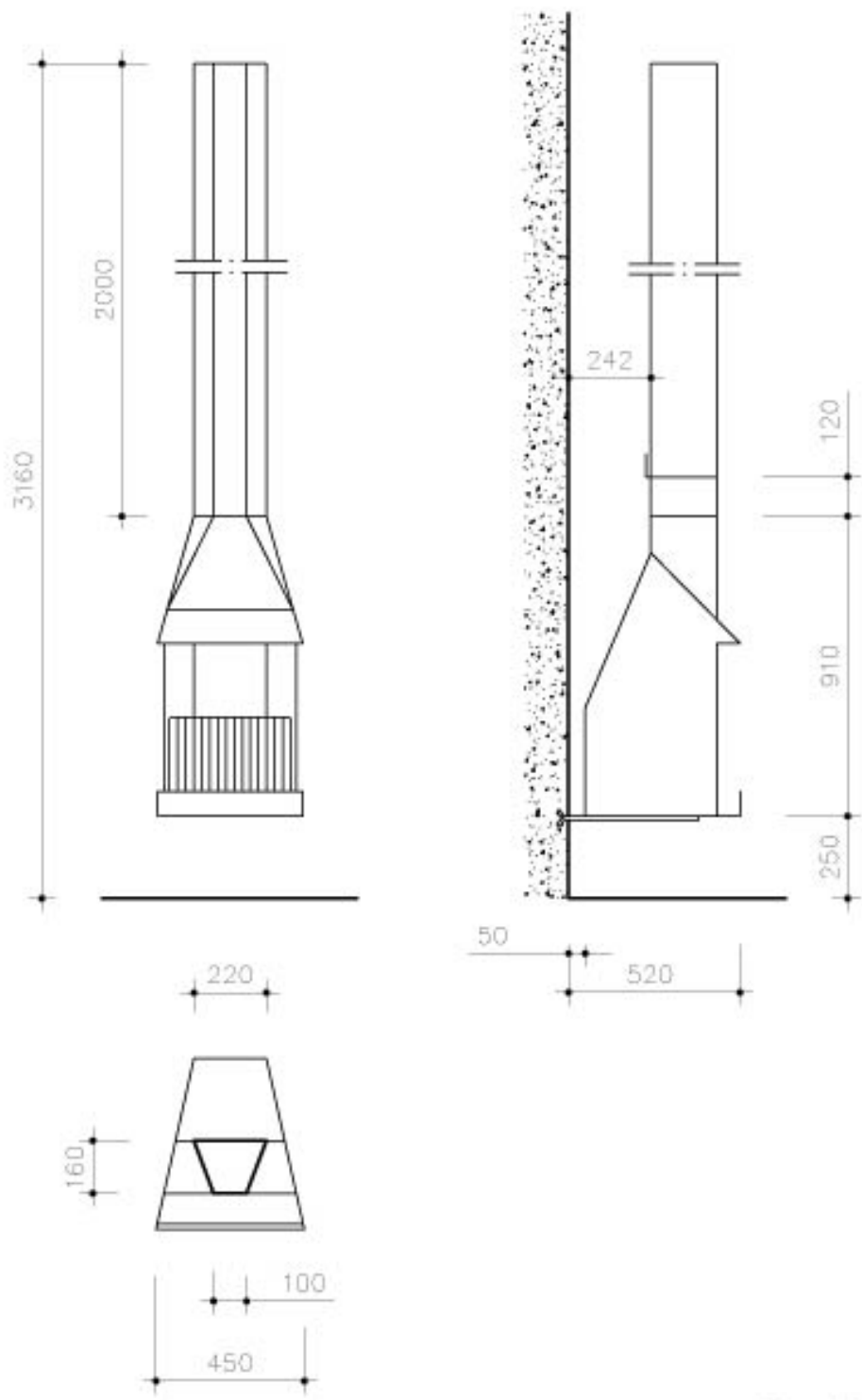

DAE
CHIMENEAS
 Chimenea CAPILLA
 Diseño: Corderch, J.A.
 Correa, F.
 Milá, A.